

by

envirovent

OZEO

Installation Manual



Ref.9023014500

INFORMATION FOR THE OWNER

Dear Resident,

Your home is equipped with an EnviroVent OZEO Mechanical Extract Ventilation System, which we recommend should operate for 24 hours a day. This system works by extracting moisture-laden air from the kitchen (through valves or/and cooker hood), toilets and bathroom using a central extractor fan.

You will normally find a 3 speed switch (optional) installed in the kitchen which controls the rate of air extraction by the fan. Guarantee 2 years.

INSTALLER INFORMATION

When you open the box, you will find the plenum chamber on top of spigots and the fan/motor assembly. If the fan is not to be mounted on a solid wall the use of an anti-vibration cushion is recommended which can be supplied as an optional extra.

For all other circumstances, mount the fan directly on to the wall with the 4 fixing screws.

DESCRIPTION

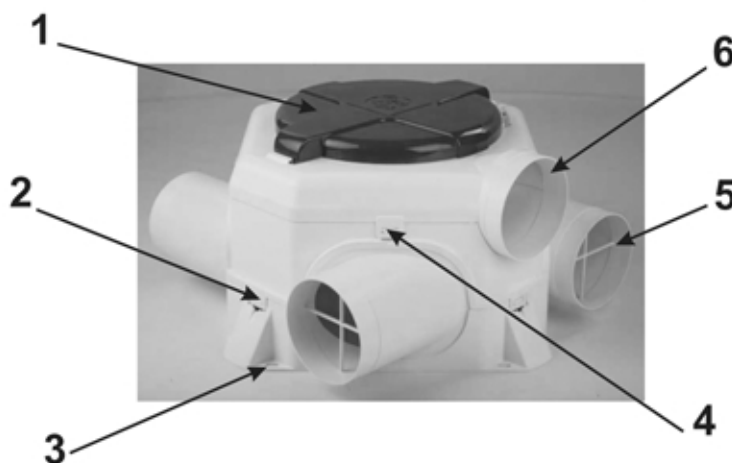

- 1 - Electrical cover
- 2 - Clamps to access plenum box (x4)
- 3 - Mounting feet (x4)
- 4 - Clamps to access fan (x4)
- 5 - Exhaust air spigots to pivot 90° Ø125mm (x4)
- 6 - Discharge air spigot to pivot 360° Ø125mm (x4)

1

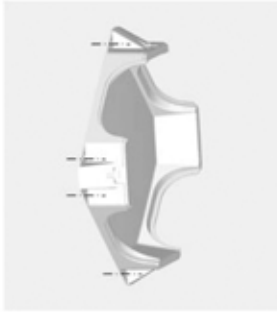

Screw the plenum chamber to the wall.

2

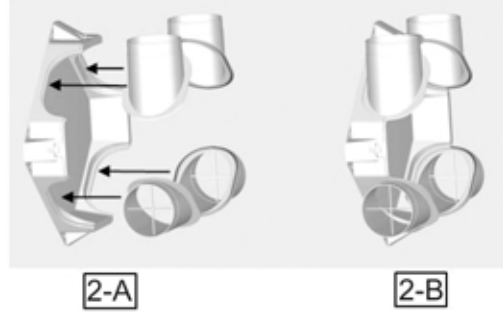

Position the spigots in the desired direction.

3

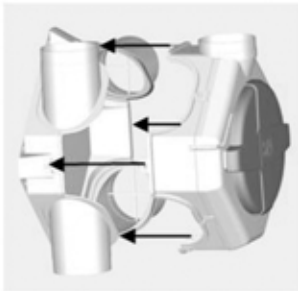

Fit the fan assembly to the plenum box.

4



Connect the ducts.

ELECTRICAL CONNECTION

5

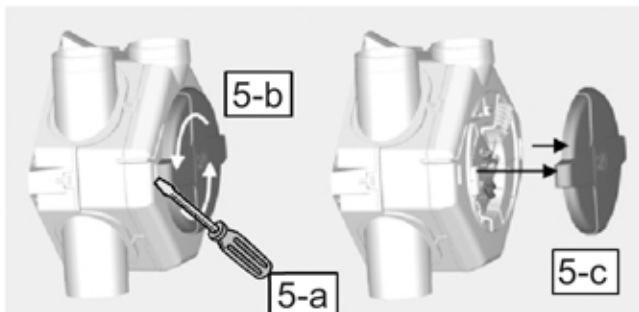

Electrical box access.

6



Wiring diagram.

7

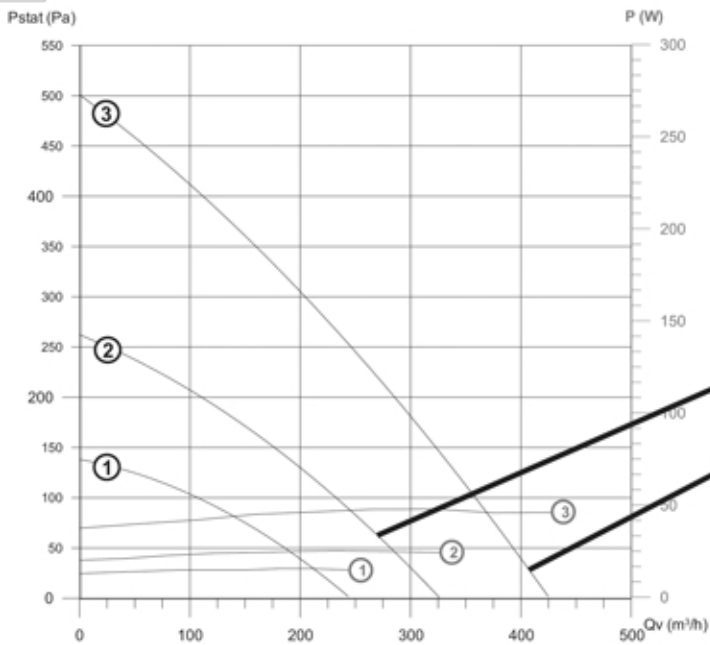

If a particular airflow rate is required that is unachievable in setting 1, setting 2 can be used to achieve a lower airflow. This would make setting 1 obsolete.

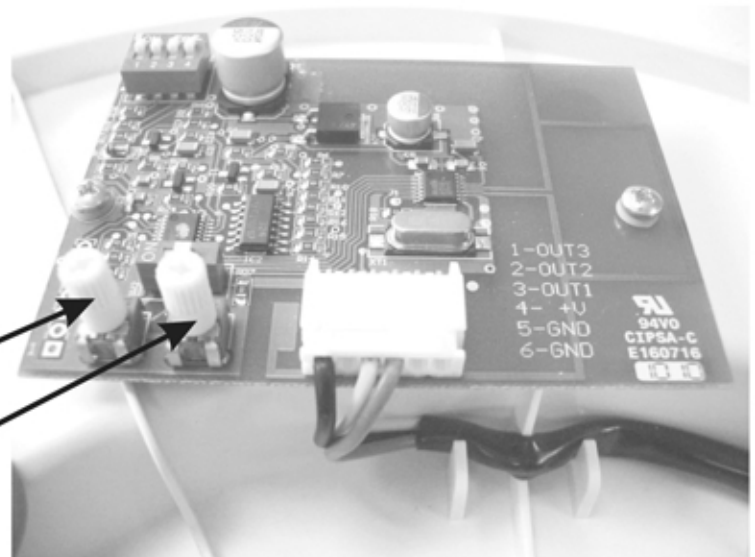

Speed 1 is fixed
Adjust the speed 2 and 3 with potentiometers

ADJUSTMENT CHANNELS OF COMMUNICATION

8

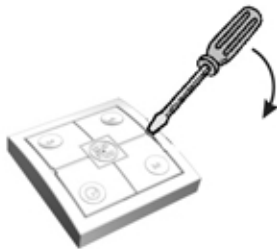

Open the cover and remove the plastic strip from battery.

9

Electronic card of the remote control.

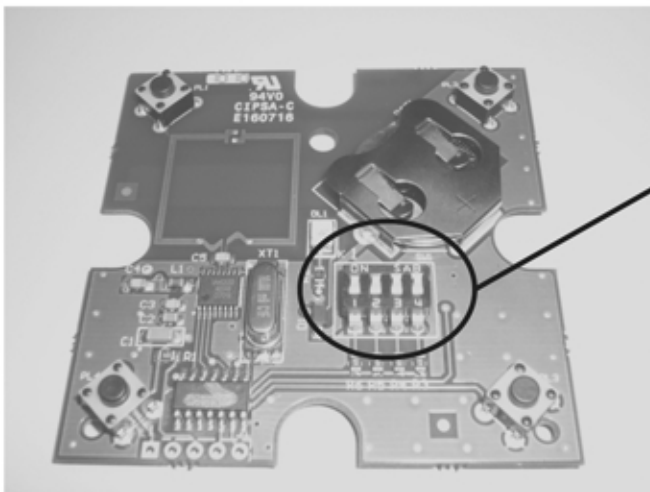

Electronic card of the fan.

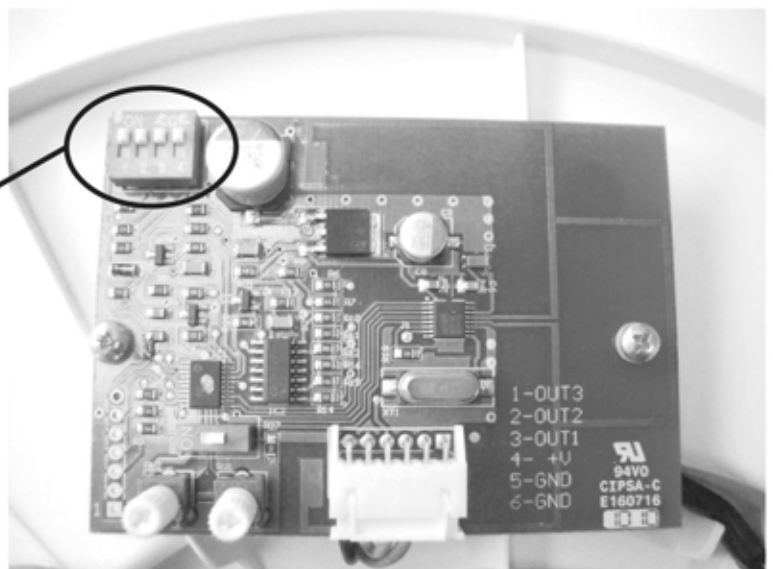

Ensure the configuration of the switches on the remote control board and on the fan board are the same (Up to 16 possibilities)

10

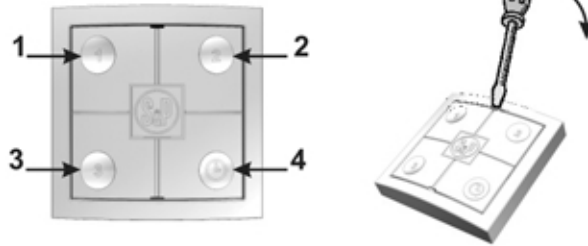

- 1 - Low speed
- 2 - Medium speed
- 3 - High speed
- 4 - Timer (30')

Before using, open the cover and remove the plastic strip from battery.

MAINTENANCE

11

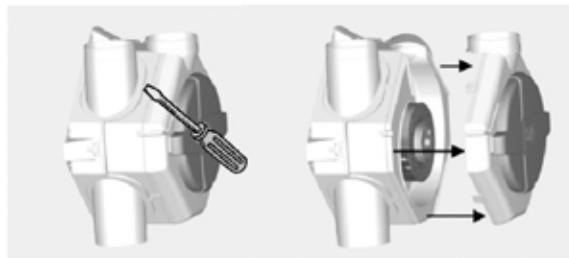

11-A

11-B

Disconnect the motor from the electrical supply before carrying out any work on the fan.



EnviroVent Ltd
Envirovent House
Hornbeam Business Park
Harrogate
HG2 8PA
01423 810 810
info@envirovent.com
www.envirovent.com